

Before use, please read these instructions carefully. And keep them in a safe place for future reference when needed.

Allergic rhinitis Acute rhinitis

第2類医薬品

鼻づまり、鼻みずに

CGM 雪の元点鼻スプレー

Nasal spray containing naphazoline hydrochloride.

Acute rhinitis and allergic rhinitis manifest as symptoms like runny nose, nasal congestion, and sneezing. This product is in a spray form, allowing the effective ingredients to be misted into the nasal cavity, suppressing inflammation of the nasal mucosa and improving these discomforting symptoms.

Usage precautions

Things not to do

And who should not use it: People who have experienced allergic reactions to this product or its ingredients should not use it. Avoid prolonged continuous use.

Discussion

1. The following individuals should consult a doctor, pharmacist, or registered seller before use:

(1) Individuals currently under a doctor's treatment.

(2) Pregnant or possibly pregnant individuals.

(3) Those who have experienced allergic reactions to medications or other substances.

(4) Individuals diagnosed with the following conditions: hypertension, heart disease, diabetes, thyroid dysfunction, glaucoma.

2. If the following symptoms occur after use, they could be side effects. Therefore, please discontinue use immediately and consult a doctor, pharmacist, or registered seller with this instruction document.

Affected areas	symptoms
skin	rash, redness, itching
nose	Swelling, irritation

In rare cases, the following severe symptoms may occur. If these symptoms appear, please seek medical attention immediately.

Symptom name	symptoms
Anaphylactic shock (allergic reaction).	After use, symptoms such as skin itching, hives, hoarseness, sneezing, throat itching, difficulty breathing, palpitations, and blurred consciousness may immediately occur.

3. If symptoms do not improve after approximately 3 days of use, please discontinue use and consult a doctor, pharmacist, or registered seller with this instruction document.

〈Efficacy and Effects〉

Relief of the following symptoms caused by acute rhinitis, allergic rhinitis, or sinusitis: nasal congestion, excessive nasal discharge (runny nose), sneezing, and heaviness in the head.

〈Usage and Dosage〉

For adults (15 years and above) and children aged 7 years and above: Spray 1 to 2 times into the nasal cavity per application, 1 to 5 times per day. Additionally, maintain an interval of at least 3 hours between uses.

● Usage method



Please remove the cap.



Hold the container and press the nozzle 2 to 3 times until the liquid is sprayed out.

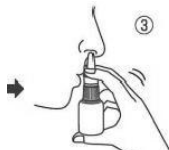

Inhale calmly and then spray 1 to 2 times into the nasal cavity.

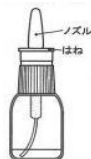

the structure of the suction tube is as shown in the diagram on the right. Due to the presence of a gentle pressure spring, the container can be used effectively even without tilting, preventing wastage.

- When using for the first time, press several times until the liquid becomes a mist.
- If the container is used sideways, the liquid will not turn into a mist, so please ensure the container is always used upright.
- If the container is used sideways, the liquid will not turn into a mist, so please ensure the container is always used upright.

⓪Precautions Regarding Dosage and Administration

- (1) Please strictly follow the prescribed usage and dosage.
- (2) Overuse may lead to nasal congestion.
- (3) If used by children, it must be under the guidance and supervision of a guardian.
- (4) For nasal application only, not for oral intake.

Ingredients	Amount in 100mL	Function
Naphazoline hydrochloride	50mg	These ingredients can constrict the blood vessels in the nasal mucosa, reducing swelling and congestion, thereby alleviating nasal blockage.
Chlorpheniramine maleate	300mg	The antihistamine effect can decrease excessive nasal discharge.
Lidocaine	100mg	The local anesthetic effect can relieve pain and discomfort.*

Additives: Parabens (hydroxybenzoates), ethanol, pH adjuster, glycerin.

【Storage and Handling Precautions】

- (1) Store in a cool place away from direct sunlight and keep the lid securely closed.
- (2) Place out of reach of children.
- (3) Do not transfer to another container. (This may lead to misuse or alter the quality of the product.)
- (4) Do not share with others.
- (5) Do not use if the product is past its expiration date. Even if within its shelf life, once opened, use as soon as possible to maintain its quality.

For inquiries about this product, you can contact the pharmacy or drugstore where you purchased it, or the "Customer Inquiry Center" below.

Seller: **CGM Innovation Co.,Ltd.**

Address: 〒110-0003 3-9-16 Negishi, Taito-ku, Tokyo, Japan

<https://www.cgmgroupp.jp>

Customer Inquiry Center: TEL 03-6811-2345. Operating hours: 9:00-17:00 (excluding Saturdays, Sundays, and public holidays).